

ALERTMAXX2 (DMS-298/299)



OVERVIEW & FEATURES

The AlertMaxx2 is an intelligent high level alarm, designed to alert homeowners when water levels in their pump chamber/s become too high. The unit will also inform homeowners when a service is due on their pump station.

AlertMaxx2 can be a stand alone high level alarm or it can be registered to connect through Wi-Fi via one of the Packaged Pump Systems 'PumpAware' or 'PumpSecure' plans. With a 'PumpSecure' plan, PPS monitor your pump station in real time and detect if and when something is going to go wrong, before it does. PPS will be alerted to faults immediately, rather than waiting for them to be discovered. The AlertMaxx2 gives 24/7/365 predictive peace of mind - all you need to do is be there to let their engineer in.

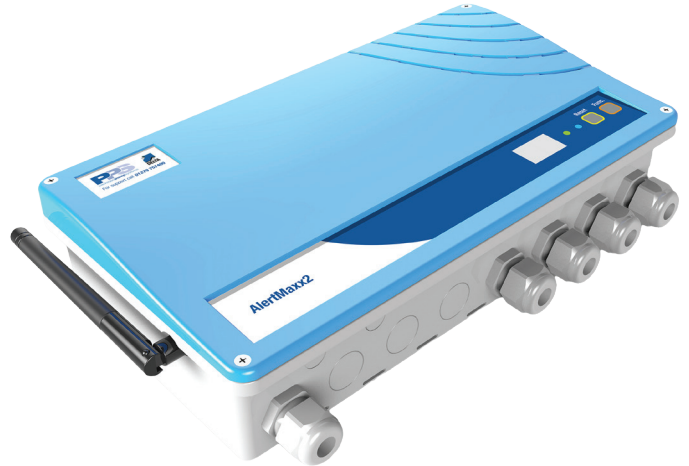

TECHNICAL SPECS.

Size	310mm x H: 170mm x D: 78mm
Weight	1000g (including battery)
Ground Water Part No.	DMS-298
Foul Water Part No.	DMS-299
Power	200-250V AC (50Hz)
Internal Battery	Pb 6V - 1.2Ah
Sounder	100db @ 30cm Sounder
Operating Temperature	5-40°C
Power Consumption (Idle)	<2W
IP	IP2X
Electrical Requirements (Ground)	2 Spurs
Electrical Requirements (Foul)	1 Spur

GUARANTEE

AlertMaxx2 is offered with a 24 month component guarantee. This guarantee only covers any defects in workmanship, construction or material. This guarantee does not cover, defects caused by incorrect installation, installer error, abnormal working conditions, misuse or neglect.



HEALTH & SAFETY

In order to minimise the risk of ill health or accidents when installing and/or servicing pump chambers and associated accessories, workers must be fully trained and competent. The following guidelines will help safeguard matters:

- Assessing the risk and working in accordance with the control measures identified.
- Ensure electrical power to the equipment is isolated before carrying out installation or maintenance.
- A suitable first aid kit must be close to hand.
- The electrical installation must comply with the requirements of BS 7671:2008 'Requirements for Electrical Installations' incorporating amendment 3:2015.

CONNECTIVITY

Wi-Fi - to enable this feature, the AlertMaxx2 will have to be connected by PPS free of charge. For more info on this, please visit: www.ppsgroupuk.com/servicing

Battery Backup - the AlertMaxx2 can be used in conjunction with the Delta PowerMaxx, PowerMaxx+ and Hi-PowerMaxx.

Volt Free - the AlertMaxx2 has volt free contacts to connect with external devices such as an alarm or beacon with a maximum load of 0.5A and voltage up to 30V. This can also be connected to any BMS system if required. The VFR sends a continuous signal.

© 2017 Delta Membrane Systems Ltd. All rights reserved. [AMX2-PL-V3-12.17]

ALERTMAXX2 (DMS-298/299)



TECHNICAL DRAWINGS

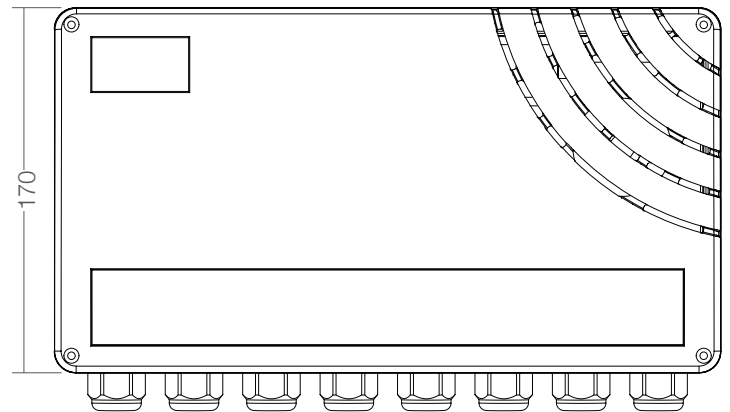
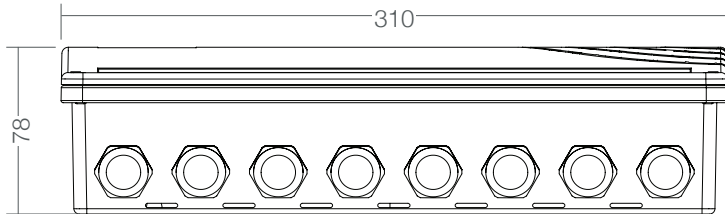

WIRING DIAGRAM - FOUL WATER

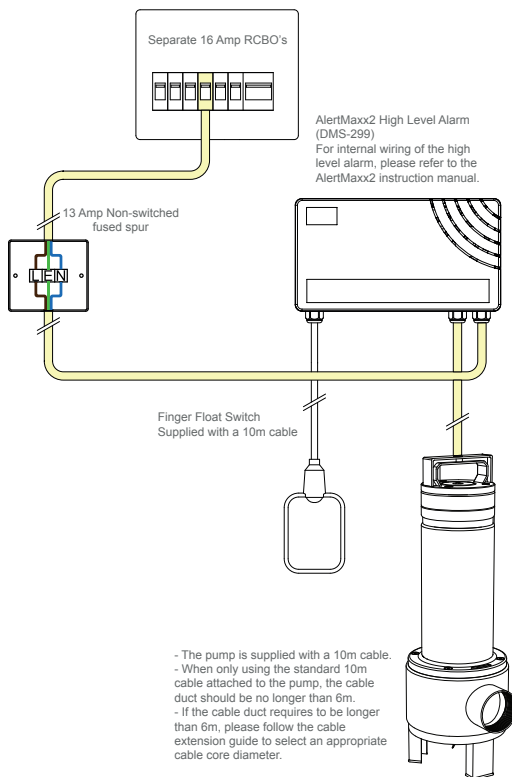

WIRING DIAGRAM - GROUND WATER

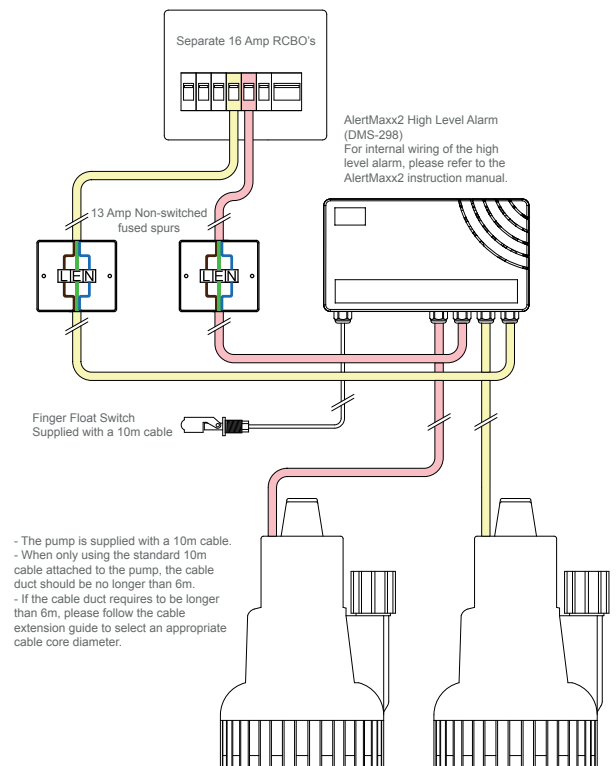

© 2017 Delta Membrane Systems Ltd. All rights reserved. [AMX2-PL-V3-12.17]