



Description

Delta Channel is a distinctive yellow, PVC drainage conduit designed to collect and manage water ingress from Type C membranes as part of a cavity drained protection system.

Delta Channel is installed at the bottom of a cavity drain membrane at the wall/floor junction, the drainage channel effectively collects and channels water to a suitable outlet such as a sump chamber.

Delta Channel has additional performed holes along the top to allow water from surface (floor) membranes to easily enter the channel.

Drainage channels ideally should be installed in rebates and laid level at the wall/floor junction around the perimeter of the structure to allow water to drain by hydraulic gradient and to discharge passively into sump chambers. For larger projects, cross-floor span channels should be included in designs. Inspection and access ports should be included in the perimeter drainage channel design.

These allow for inspection, maintenance, and future cleaning of the drainage system.

Delta Channel is available with or without upstand.

Delta Channel with upstand keeps the channel stable when abutting the Delta cavity drainage membrane on a perimeter wall.

Channel without upstand is used where cross channels sit over construction joints in the middle of the floor, when Delta Channel is to be offset from the wall or to join two perimeter channels together across a floor.

Product Details

- DMS 207 Channel with Upstand
- DMS 208 Channel without Upstand

Technical Data

Delta Channel	
Available with Upstand	DMS 207
Available without Upstand	DMS 208
Material	PVC
Colour	Yellow
Length	2 Metres
Country of Manufacturer	United Kingdom

Technical Drawing - DW-123-1-(C)

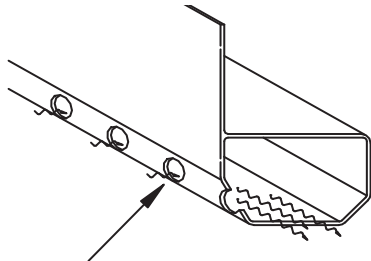

WATER DRAINS INTO BACK OF CHANNEL

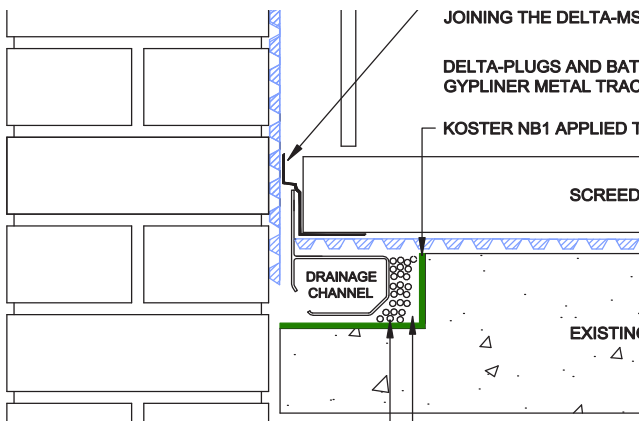

### Features

- Yellow for ease of cleaning, inspection and maintenance
- Channels water to a suitable evacuation point
- Compatible with all Delta basement drainage connectors
- Compatible with Delta Inspection Ports to allow for cleaning, inspection and maintenance

### Fields of Application

- Essential part of a Type C Cavity Drained Protection system
- Essential part of a Basement Drainage System
- Channels water to a safe point of discharge
- Protects structures from water ingress

### Specification

- BS 8102:2022 Protection of below ground structures against water ingress. Code of practice.
- NBS Specification R18 (Clause 310) Pumping Stations and Pressure Pipelines

### Associated Products

- DMS 310 Straight Connectors
- DMS 182 Corner Piece
- DMS 183 T Piece
- DMS 184 End Caps
- DMS 128 110mm Drainage Outlet

### Other Information

All data and information contained in these Product/Technical Data Sheets is up-to-date and correct as at the date of issue. The information given is suggested as guidance and should only be used for evaluating your specific application. Delta Membrane Systems Limited cannot control or anticipate the conditions under which this product may be used, each user should review the information in specific context of the planned use. The information contained in these Product/Technical Data Sheets should not be considered a warranty, expressed, or implied, including but not limited to a warranty of merchantability or fitness for a particular purpose. In no event shall Delta Membrane Systems Limited be liable for any incidental or consequential damages resulting from the use, misuse, or inability to use the product. This exclusion applies regardless of whether such damages are sought based on breach of warranty, breach of contract, negligence, strict liability in tort, or any other legal theory. When in doubt, contact Delta's Technical Team on 01992 523 523.